

NEW

Flat Ejector Pin with corner radii and DLC-coating

- » ready to be installed
- » burrless injection mouldings
- » high accuracy in shape
- » extreme resistance to adhesive friction
- » excellent corrosion resistance
- » lower tooling and machine downtime costs
- » will not mark or discolour the end product
- » excellent dry-run properties

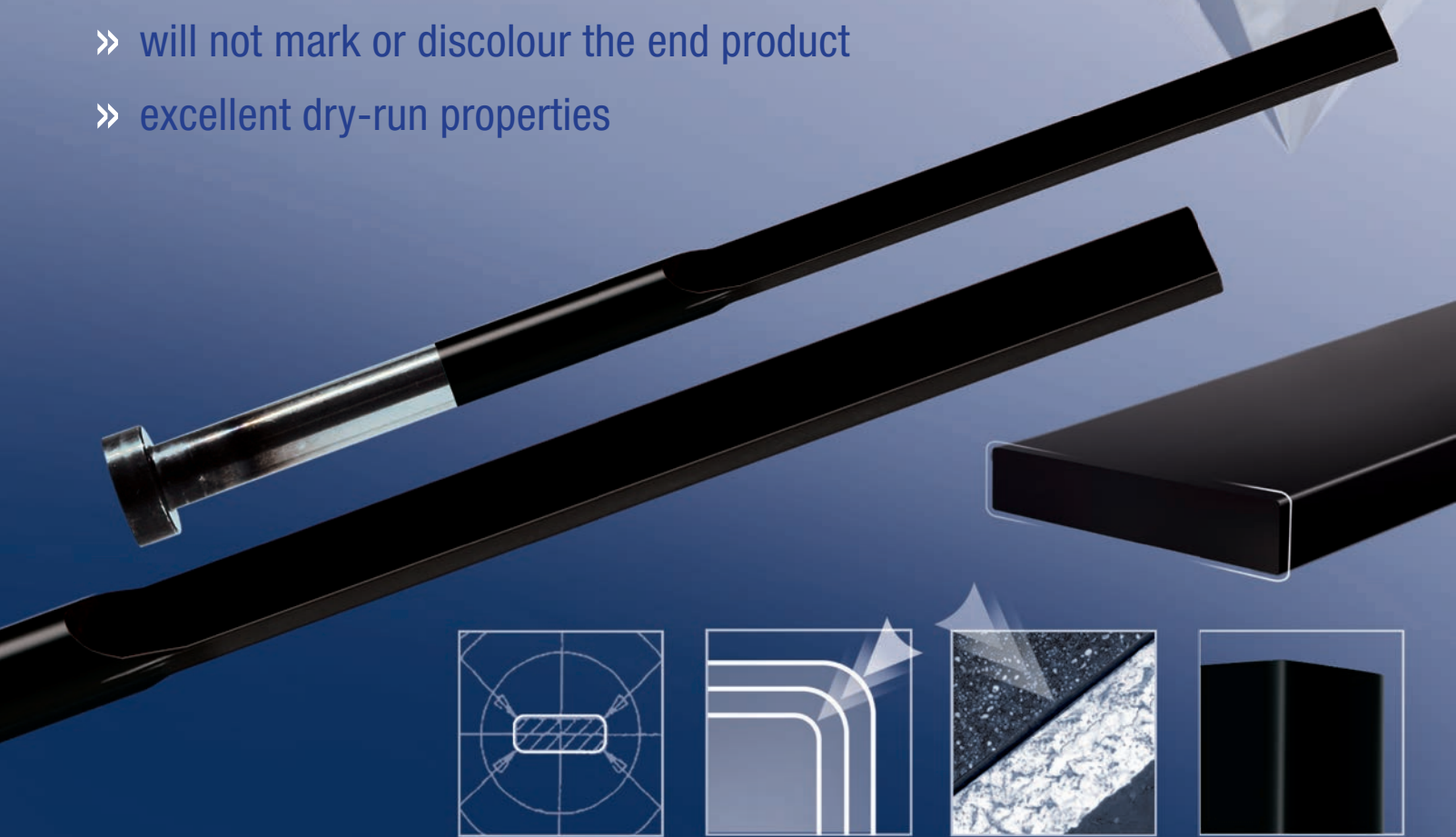

Increased productivity using precise and reliable products by Eberhard!



Eberhard
TOOL TECHNOLOGY

Flat Ejector Pin with corner radii and DLC-coating

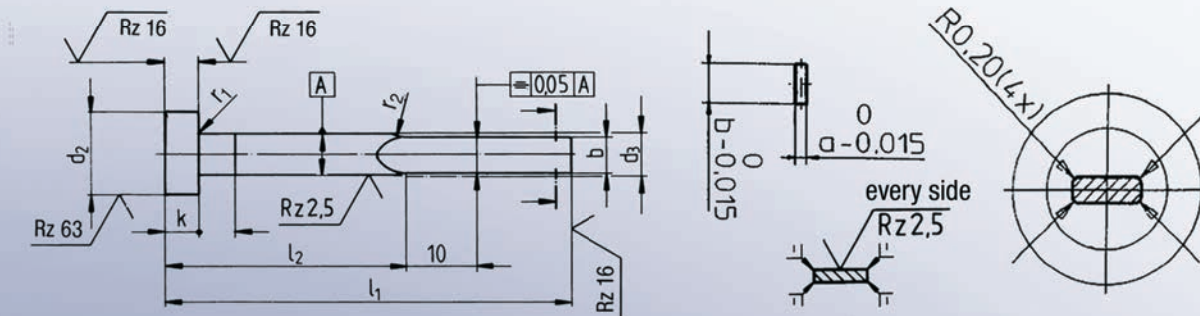

- » article no.: 6R41.
- » version: head hot forged – shaft hardened, tempered and fine grinded
- » materials: WS
- » hardness of coating: ca. 3000 HV
- » thickness of coating: 2-3 μm
- » coating temperature: ca. 180°C
- » colour of coating: black-grey

Please note, that there could be an increase in size a, b and d_3 by a few μm due to the application of the coating.

More
information



Shop online



Eberhard
TOOL TECHNOLOGY



Auswerferstifte mit zylindrischem Kopf

Ejector pin with cylindrical head

Schaft rechteckig abgesetzt mit DLC-Beschichtung – Flachauswerfer nach DIN ISO 8693 (DIN 1530 Teil 4, Form FAH, gehärtet)
 rectangular stepped point with DLC-coating – blade ejector according to DIN ISO 8693 (DIN 1530 part 4, type FAH, hardened)

mit 4 Eckenradien 0,2
 with 4 corner radii 0,2



NEU / NEW
 DLC-Beschichtung
 DLC-coating

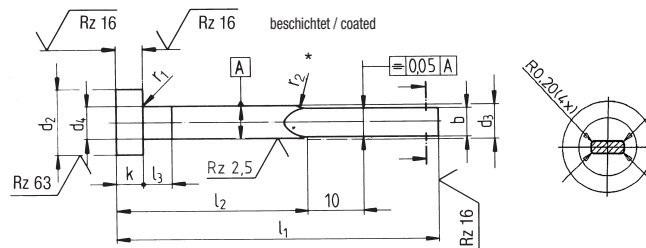

Artikel-Nr.: 6R41 .

Item no.: 6R41 .

Werkstoff: WS
 Weitere Werkstoffe auf Anfrage erhältlich.
 Siehe Seite 5.09–5.10

Material: WS
 For other materials
 see page 5.09–5.10

Härte: Schaft: HRC 60 ± 2
 Kopf: HRC 45 ± 5

Hardness: Shaft: HRC 60 ± 2
 Head: HRC 45 ± 5

Andere Radientoleranzen, -anzahl und -größen
 auf Wunsch erhältlich.

Other tolerances, quantities and sizes of radii
 are available on request.

a	b	d ₃	d ₂	k	r ₁	r ₂	l ₁ + 2/0															
							80	100	125***	160	200	250										
0 -0,015 *	0 -0,015 *	h11	0 -0,2	0 -0,05	+ 0,2 0	min	l ₂ - 1/- 2															
							40	50	60	80	100	125										
0,8	2,8	3	6	3	0,3	10		●	●	●												
1,0								●	●	●	●											
0,8	3,8	4,2	8	3	0,3		●	●	●	●	●	●	●									
1,0							●	●	●	●	●	●	●	●	●	●						
1,2							●	●	●	●	●	●	●	●	●	●	●					
1,0	4,5	5	10	3	0,3		●	●	●	●	●	●	●	●	●	●	●	●				
1,2							●	●	●	●	●	●	●	●	●	●	●	●	●	●	●	
1,5							●	●	●	●	●	●	●	●	●	●	●	●	●	●	●	●
1,0	5,5	6	12	5	0,5		●	●	●	●	●	●	●	●	●	●	●	●	●			
1,2							●	●	●	●	●	●	●	●	●	●	●	●	●	●	●	●
1,5						●	●	●	●	●	●	●	●	●	●	●	●	●	●	●	●	●
2,0						●	●	●	●	●	●	●	●	●	●	●	●	●	●	●	●	●
1,2	7,5	8	14	5	0,5	●	●	●	●	●	●	●	●	●	●	●	●	●				
1,5						●	●	●	●	●	●	●	●	●	●	●	●	●	●	●	●	
2,0						●	●	●	●	●	●	●	●	●	●	●	●	●	●	●	●	●
1,5	9,5	10	16	5	0,5	●	●	●	●	●	●	●	●	●	●	●	●	●				
2,0						●	●	●	●	●	●	●	●	●	●	●	●	●	●	●	●	

● = Ab Lager lieferbar. Übrige Abmessungen auf Anfrage.

● = Available from stock. Other dimensions on request.

* Diese Grenzabmaße gelten für 100 mm Länge (l₂). Für Längen (l₂) > 100, sind die Grenzabmaße mit (l₁-l₂) 10⁻² zu multiplizieren. Die Maßtoleranz erreicht in der Ebene 2 ihren Höchstwert.
 ** Bei Bestellung bitte d₃ mit angeben.

* These limit values apply for 100 mm lengths (l₂). For lengths (l₂) > 100 the limit values are to be multiplied by (l₁-l₂) 10⁻². The tolerance value reaches its maximum at the second level.
 ** Please state with order d₃.